



## P-02 CORNER PLASTER PROFILE

### Description

#### **P-02 POFIX CORNER PLASTER PROFILE**

**P-02 CORNER PLASTER PROFILE** profile for dry construction or for thin and thick plaster coatings. Corner plaster profiles for dry construction serve to protect edges and corners against mechanical damage. The profiles are manufactured in various designs and materials. Profiles must face the middle of the board to be smoothed out. They may be used for horizontal and vertical places.

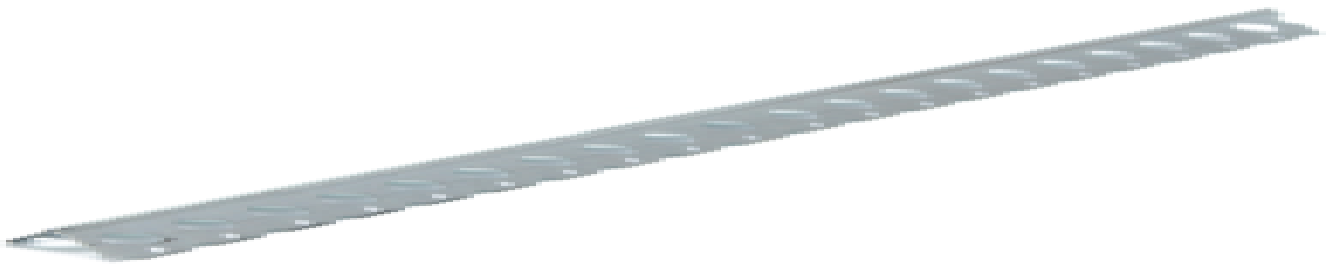



### Specifications Parameters

length	2800 mm
Application thickness	1.5 mm.
length of one side	22 mm.
length of the second side	22 mm.
Material	al

## Specifications Parameters

Color (silver)

### Date Created

14.05.2023

### Author

admin

POFIX